

LOCATION

Property Address	4 Mile Creek Rd TN
Subdivision	
County	Morgan County, TN

GENERAL PARCEL INFORMATION

Parcel ID/Tax ID	080 096.00
Special Int	000
Alternate Parcel ID	
Land Map	080
District/Ward	
2020 Census Trct/Blk	1102/2
Assessor Roll Year	2024

PROPERTY SUMMARY

Property Type	Residential
Land Use	
Improvement Type	
Square Feet	

SCHOOL INFORMATION

These are the closest schools to the property

Sunbright School	13.2 mi
Elementary: Pre K to 1	Distance
Central Elementary School	16.2 mi
Elementary: Pre K to 5	Distance
Central Middle School	18.0 mi
Middle: 6 to 8	Distance
Central High School	15.7 mi
High: 9 to 12	Distance

TAX ASSESSMENT

Appraisal	Amount	Assessment	Amount	Jurisdiction	Rate
Appraisal Year	2025	Assessment Year	2025		
Appraised Land	\$26,300	Assessed Land		Morgan	2.719
Appraised Improvements		Assessed Improvements			
Total Tax Appraisal	\$26,300	Total Assessment	\$6,575		
		Exempt Amount			
		Exempt Reason			

TAXES

Tax Year	City Taxes	County Taxes	Total Taxes
2025		\$178.77	\$178.77
2024		\$178.77	\$178.77
2023		\$178.77	\$178.77

MORTGAGE HISTORY

No mortgages were found for this parcel.

PROPERTY CHARACTERISTICS: BUILDING

No Buildings were found for this parcel.

PROPERTY CHARACTERISTICS: EXTRA FEATURES

No extra features were found for this parcel.

PROPERTY CHARACTERISTICS: LOT

Land Use		Lot Dimensions	
Block/Lot		Lot Square Feet	473,931
Latitude/Longitude	36.140077°/-84.861896°	Acreage	10.88

PROPERTY CHARACTERISTICS: UTILITIES/AREA

Gas Source	Public - Natural Gas	Road Type	
Electric Source	Public	Topography	
Water Source	Public	District Trend	
Sewer Source	Public	Special School District 1	
Zoning Code		Special School District 2	
Owner Type			

LEGAL DESCRIPTION

Subdivision		Plat Book/Page	
Block/Lot		District/Ward	
Description			

FEMA FLOOD ZONES

Zone Code	Flood Risk	BFE	Description	FIRM Panel ID	FIRM Panel Eff. Date
X	Minimal		Area of minimal flood hazard, usually depicted on FIRMs as above the 500-year flood level.	47129C0175C	06/18/2007



Kenny Phillips
Powell Auction & Realty
8659383403
kenny@powellauction.com

Map for Parcel Address: 4 Mile Creek Rd TN Parcel ID: 080 096.00





Kenny Phillips
Powell Auction & Realty
8659383403
kenny@powellauction.com

Map for Parcel Address: 4 Mile Creek Rd TN Parcel ID: 080 096.00

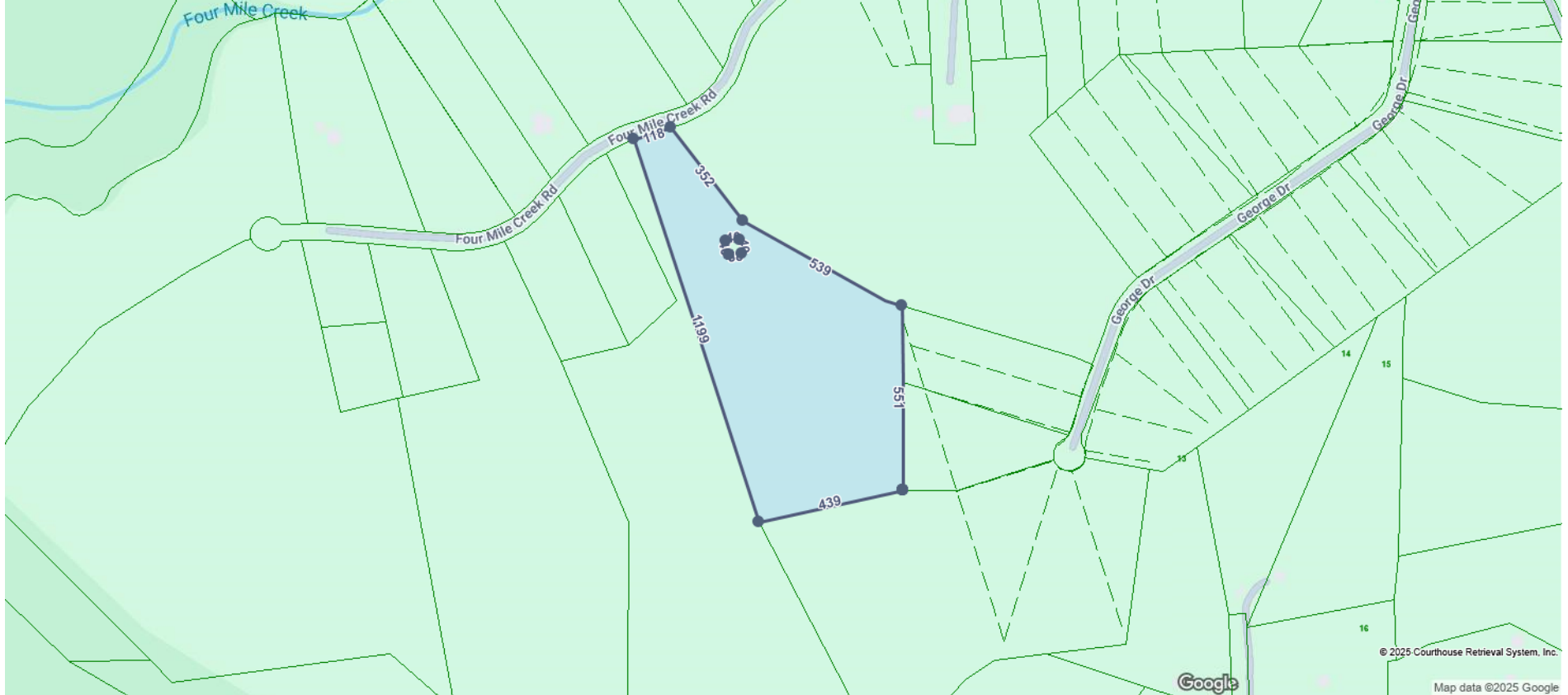



LOCATION

Property Address	4 Mile Creek Rd TN
Subdivision	
County	Morgan County, TN

GENERAL PARCEL INFORMATION

Parcel ID/Tax ID	080 101.00
Special Int	000
Alternate Parcel ID	
Land Map	080
District/Ward	
2020 Census Trct/Blk	1102/2
Assessor Roll Year	2024

PROPERTY SUMMARY

Property Type	Commercial
Land Use	
Improvement Type	
Square Feet	

SCHOOL INFORMATION

These are the closest schools to the property

Sunbright School	13.2 mi
Elementary: Pre K to 1	Distance
Central Elementary School	16.3 mi
Elementary: Pre K to 5	Distance
Central Middle School	18.1 mi
Middle: 6 to 8	Distance
Central High School	15.7 mi
High: 9 to 12	Distance

TAX ASSESSMENT

Appraisal	Amount	Assessment	Amount	Jurisdiction	Rate
Appraisal Year	2025	Assessment Year	2025		
Appraised Land	\$400	Assessed Land		Morgan	2.719
Appraised Improvements		Assessed Improvements			
Total Tax Appraisal	\$400	Total Assessment	\$160		
		Exempt Amount			
		Exempt Reason			

TAXES

Tax Year	City Taxes	County Taxes	Total Taxes
2025		\$4.35	\$4.35
2024		\$4.35	\$4.35
2023		\$4.35	\$4.35

PROPERTY CHARACTERISTICS: BUILDING

No Buildings were found for this parcel.

PROPERTY CHARACTERISTICS: EXTRA FEATURES

No extra features were found for this parcel.

PROPERTY CHARACTERISTICS: LOT

Land Use		Lot Dimensions	
Block/Lot		Lot Square Feet	1,307
Latitude/Longitude	36.140904°/-84.862399°	Acreage	0.03

PROPERTY CHARACTERISTICS: UTILITIES/AREA

Gas Source	Public - Natural Gas	Road Type	
Electric Source	Public	Topography	
Water Source	Public	District Trend	
Sewer Source	Public	Special School District 1	
Zoning Code		Special School District 2	
Owner Type			

LEGAL DESCRIPTION

Subdivision		Plat Book/Page	
Block/Lot		District/Ward	
Description			

FEMA FLOOD ZONES

Zone Code	Flood Risk	BFE	Description	FIRM Panel ID	FIRM Panel Eff. Date
X	Minimal		Area of minimal flood hazard, usually depicted on FIRMs as above the 500-year flood level.	47129C0175C	06/18/2007



Kenny Phillips
Powell Auction & Realty
8659383403
kenny@powellauction.com

Map for Parcel Address: 4 Mile Creek Rd TN Parcel ID: 080 101.00





Kenny Phillips
Powell Auction & Realty
8659383403
kenny@powellauction.com

Map for Parcel Address: 4 Mile Creek Rd TN Parcel ID: 080 101.00

